

PLAN VIEW AT LEVEL (J) 125.000M

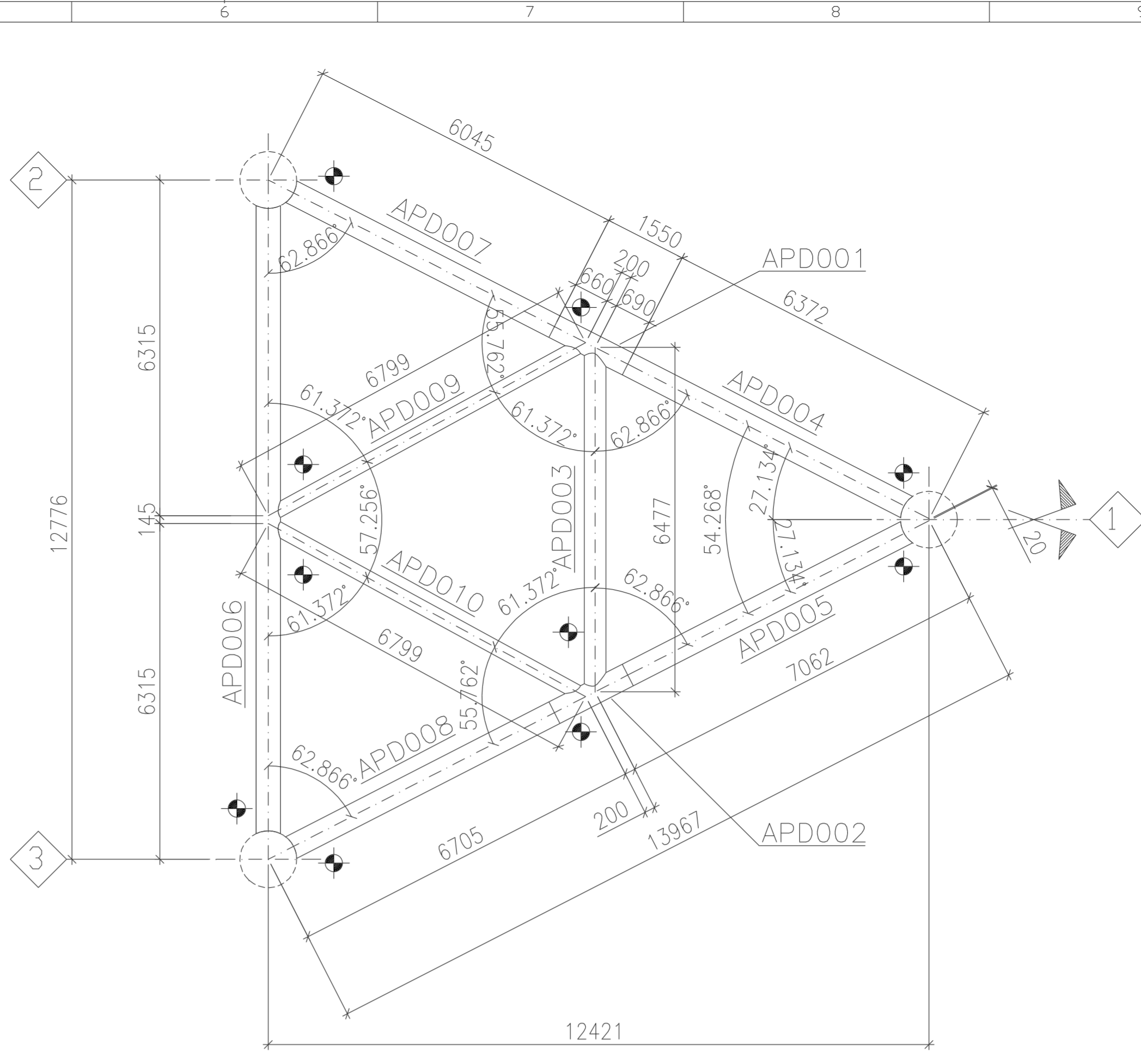

PLAN VIEW AT LEVEL (I) 145.000M

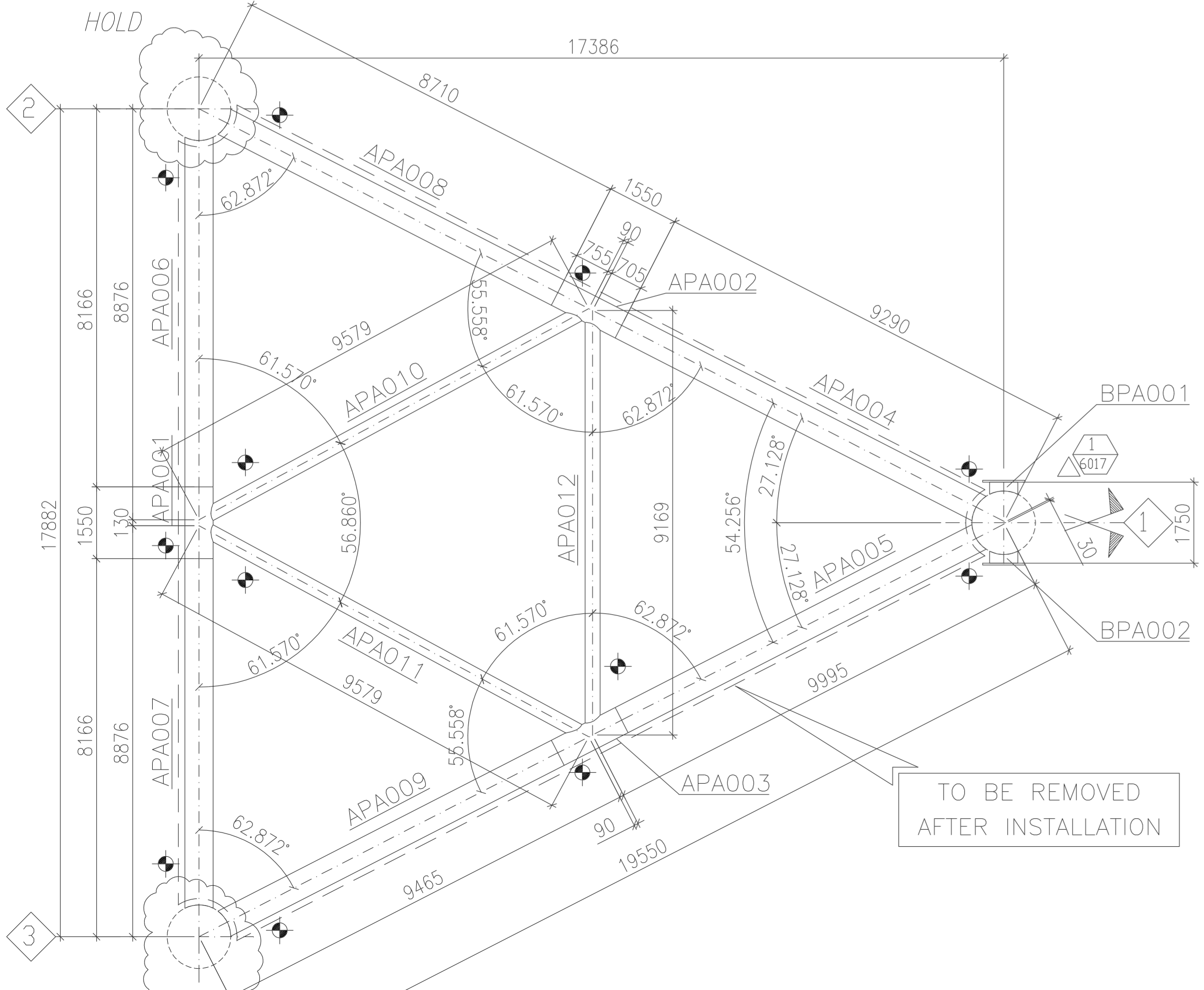

PLAN VIEW AT LEVEL (K) 101.500M

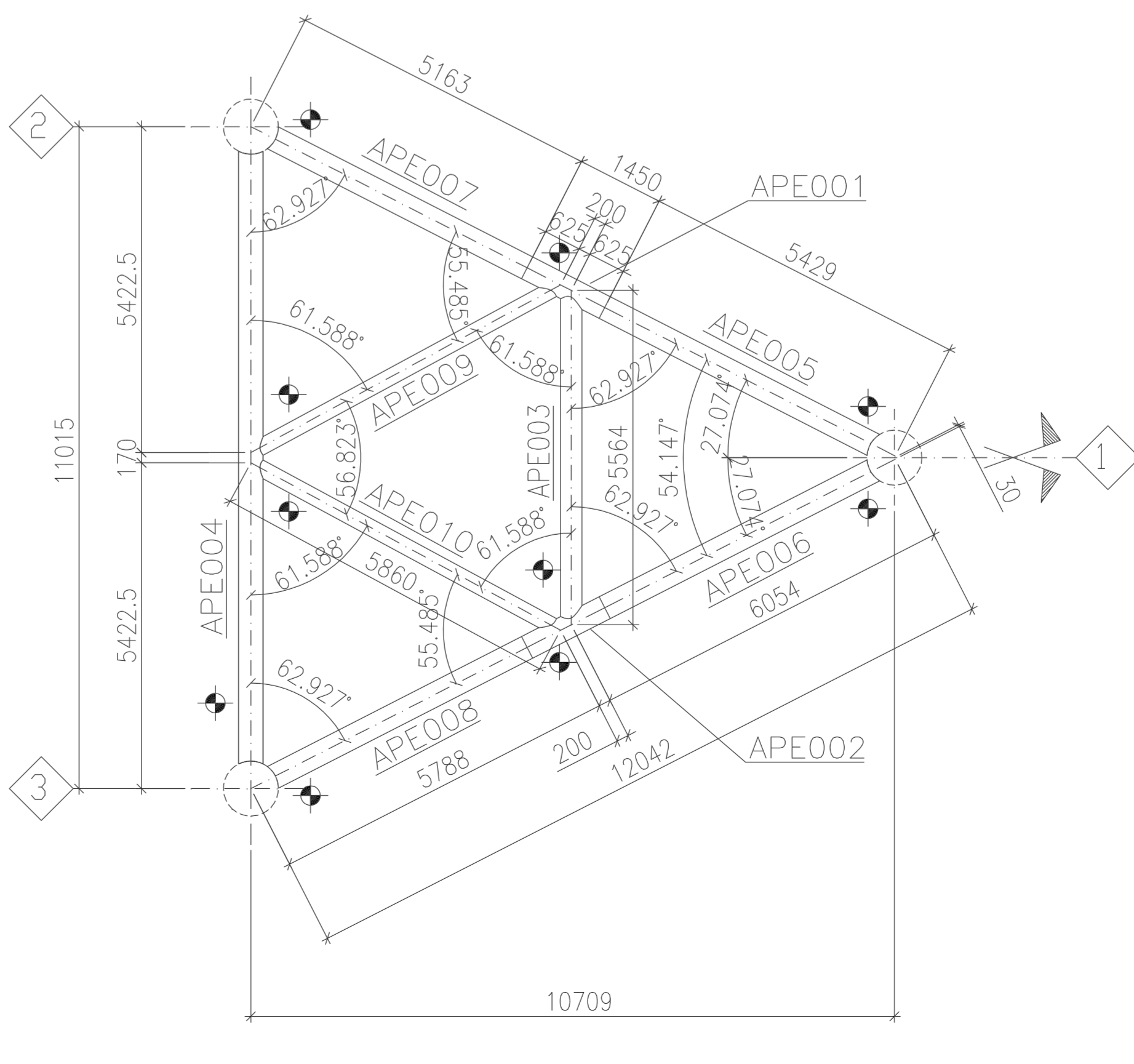

PLAN VIEW AT LEVEL (H) 160.000M

MATERIAL LIST										
ITEMS	QTY	DESIGNATION	MATERIAL	L.A.V UNIT	L.A.V TOTAL	WEIGHT UNIT	WEIGHT TOTAL	CAT	TYR	
001	3	609.6x1.9.1 (24"x0.750)	BS71 91 355EMZ	1.550	4.650	277.44	1290	A	II	
002	2	508.0x25.4 (20"x1.000)	BS71 91 355EMZ	3.400	6.800	302.30	2056	A	II	
003	1	508.0x25.4 (20"x1.000)	BS71 91 355EMZ	1.790	1.790	302.30	541	A	II	
004	2	457.2x25.4 (18"x1.000)	BS71 91 355EMZ	1.550	3.100	270.48	838	A	II	
005	2	457.2x1.9.1 (18"x0.750)	BS71 91 355EMZ	1.913	3.826	205.84	788	A	II	
006	2	406.4x25.4 (16"x1.000)	API 5L X52	1.450	2.900	238.66	692	A	II	
007	1	406.4x1.9.1 (16"x0.750)	API 5L X52	6.268	6.268	181.98	1141	A	II	
008	1	355.6x1.9.1 (14"x0.750)	API 5L X52	5.369	5.369	158.11	849	A	II	
009	1	609.6x1.2.7 (24"x0.500)	BS71 91 355EM	8.691	8.691	186.95	1625	B	II	
009	1	609.6x1.2.7 (24"x0.500)	BS71 91 355EM	8.691	8.691	186.95	1625	B	II	
010	1	609.6x1.2.7 (24"x0.500)	BS71 91 355EM	7.550	7.550	186.95	1411	B	II	
010	1	609.6x1.2.7 (24"x0.500)	BS71 91 355EM	7.550	7.550	186.95	1411	B	II	
011	1	609.6x1.2.7 (24"x0.500)	BS71 91 355EM	8.093	8.093	186.95	1513	B	II	
011	1	609.6x1.2.7 (24"x0.500)	BS71 91 355EM	8.093	8.093	186.95	1513	B	II	
012	1	508.0x1.2.7 (20"x0.500)	BS71 91 355EM	6.141	6.141	155.13	953	B	II	
012	1	508.0x1.2.7 (20"x0.500)	BS71 91 355EM	6.141	6.141	155.13	953	B	II	
013	1	508.0x1.2.7 (20"x0.500)	BS71 91 355EM	6.506	6.506	155.13	1009	B	II	
013	1	508.0x1.2.7 (20"x0.500)	BS71 91 355EM	6.506	6.506	155.13	1009	B	II	
014	1	508.0x1.2.7 (20"x0.500)	BS71 91 355EM	5.587	5.587	155.13	867	B	II	
014	1	508.0x1.2.7 (20"x0.500)	BS71 91 355EM	5.587	5.587	155.13	867	B	II	
015	1	457.2x1.5.9 (18"x0.625)	BS71 91 355EM	5.900	5.900	172.78	1019	B	II	
015	1	457.2x1.5.9 (18"x0.625)	BS71 91 355EM	5.900	5.900	172.78	1019	B	II	
016	1	457.2x1.5.9 (18"x0.625)	BS71 91 355EM	11.812	11.812	172.78	2041	A	II	
017	1	457.2x1.5.9 (18"x0.625)	BS71 91 355EM	7.466	7.466	172.78	1290	B	II	
018	2	457.2x1.5.9 (18"x0.625)	BS71 91 355EM	5.788	11.576	172.78	2000	B	II	
019	1	457.2x1.5.9 (18"x0.625)	BS71 91 355EM	5.562	5.562	172.78	961	B	II	
019	1	457.2x1.5.9 (18"x0.625)	BS71 91 355EM	5.562	5.562	172.78	961	B	II	
020	1	406.4x1.6.7 (16"x0.656)	API 5L X52	10.196	10.196	160.12	1633	A	II	
021	1	406.4x1.6.7 (16"x0.656)	API 5L X52	5.035	5.035	160.12	806	B	II	
021	1	406.4x1.6.7 (16"x0.656)	API 5L X52	5.035	5.035	160.12	806	B	II	
022	1	406.4x1.6.7 (16"x0.656)	API 5L X52	4.753	4.753	160.12	761	B	II	
022	1	406.4x1.6.7 (16"x0.656)	API 5L X52	4.753	4.753	160.12	761	B	II	
023	1	406.4x1.2.7 (16"x0.500)	API 5L X52	6.489	6.489	123.31	800	B	II	
024	1	406.4x1.2.7 (16"x0.500)	API 5L X52	5.907	5.907	123.31	728	B	II	
025	2	323.8x9.5 (12"x0.375)	API 5L X52	8.975	17.950	73.84	1325	B	II	
026	1	323.8x9.5 (12"x0.375)	API 5L X52	8.589	8.589	73.84	634	B	II	
027	2	273.1x9.3 (10"x0.365)	API 5L X52	6.367	12.734	60.30	768	B	II	
028	2	273.1x9.3 (10"x0.365)	API 5L X52	5.506	11.012	60.30	664	B	II	
029	2	609.6x25.4 (24"x1.000)	BS71 91 355EM	0.260	0.520	365.94	190	E	II	
TOTAL WEIGHT =							42120	KG		

NOTES:  
 1) ALL DIMENSIONS ARE IN MILLIMETRES U.N.O.  
 2) ORIENTATION MARK  
 3) MARKS: APA001-APA012, APC001-APC016, APD001-APD010, APE001-APE010, BPA001-BPA002

REFERENCE DWGS:  
 - CONTRACTOR (Saipem SA): T122010-238-NRP-99.37-60131 REV.0  
 - WELDS: T122010-WS5-SNL-IT-MR-60131-W1  
 - ASSEMBLY: -

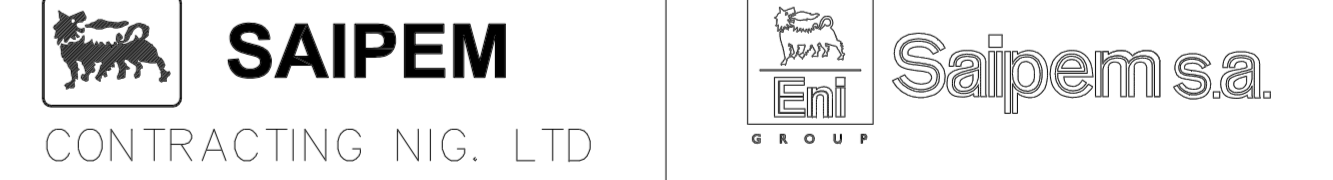
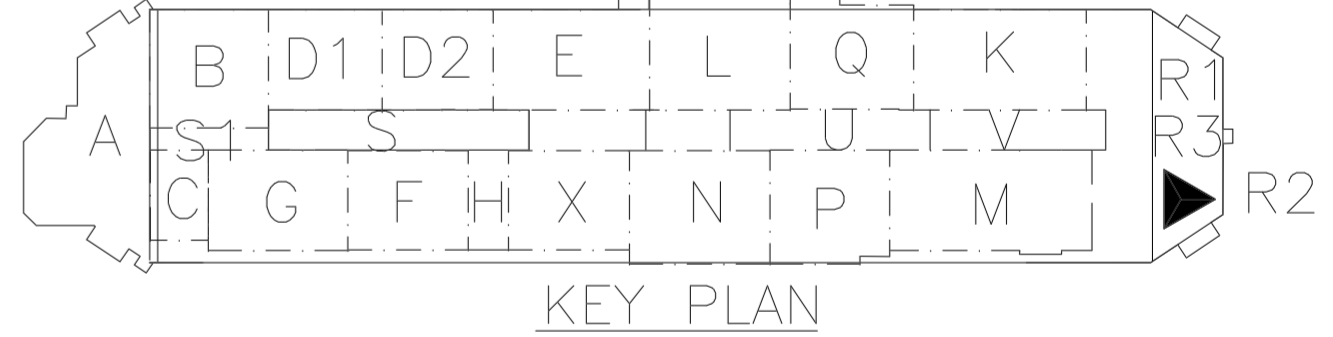

0	ISSUED FOR	MA	AI	05.10.03	
REV	DESCRIZIONE - DESCRIPTION	ESEG. PREP'D	CONTR. CHK'D	APPR. APPR'D	DATA DATE
TITOLO - TITLE		MODULE R2 - FLARE TOWER FLARE - MAIN STRUCTURE MARKS PLAN VIEWS 1			
T122010-WS5-SNL-IT-MR-60131		SCALA SCALE	FORMATO SIZE	TAVOLA SHEET	
		NTS	A1+	1/12	

SOSTITUISCE IL - REPLACES: \_\_\_\_\_ SOSTITUITO DA - REPLACED BY: \_\_\_\_\_  
 IL PRESENTE DISEGNO E' PROPRIETA' DI SAIPEM CONTRACTING NIG.LTD - A TERMINE DI LEGGE OGNI DIRITTO E' RISERVATO  
 THIS DOCUMENT IS THE PROPERTY OF SAIPEM CONTRACTING NIG.LTD - ALL RIGHTS ARE RESERVED ACCORDING TO LAW

MR-60131\_I.O.-A1+ 50 - 05.10.2003